

## INDURO™ HPL-FACED ACM

# Installation Instructions, Cleaning Instructions, & Technical Data

---

Statements expressed in this technical bulletin are recommendations for the application of Marlite brand products as outlined and illustrated under normal conditions of installation. The recommendations provided in the bulletin represent our best judgment based on our experience with normal applications. Unless prior approval is obtained in writing from Marlite, any deviation from these recommended procedures shall be at the sole risk of the installers. Carefully inspect all panels. If a panel is defective, notify the Marlite Service Center or Distributor nearest you at once. Failure to do so shall be at the sole risk of the installer. Do not store Marlite Induro™ HPL-Faced ACM Panels outside exposed to the weather and its elements.

**Important** – Read complete instructions carefully before beginning installation.

**Total System Components** – Nominal .150" thick, 4' wide panels, Aluminum Trim Molding, Titebond® Advanced Polymer Adhesive, MS-250 Clear Silicone Sealant.

**Tools Required** – Table saw or circular saw with fine-tooth jigsaw blade, drill and drill bits, caulking gun, rule/tape, file, hammer, laser level, horses/support.

**Caution** – Use a damp cloth, mild soap or detergent to clean panels. Use mineral spirits to remove excess adhesive before it dries. Do not use abrasive cleaners.

**Open package** – Carefully inspect all panels. Due to manufacturing techniques, some panels may possess minor variations in color consistency and pattern.

---

## Installation Tips

1. Install Induro™ ACM Panels when room and material temperature are approximately 70°F.
2. Application is recommended over a solid backing, such as drywall or plywood. Surface to be covered must be clean, dry, solid, straight, and free from drywall dust, bumps, projections, loose plaster, loose paint, or any unsealed joint compound wider than 3". ***For seams with excessive joint compound wider than 3", seal drywall joint using a 50/50 mixture of latex paint and water applied lightly over the drywall compound only.***
3. Maintain plumb vertical edges with plumb lines or level.
4. Do not position Induro™ ACM Panel joints directly over drywall or plywood joints.
5. Cut Induro™ ACM Panels face up using a table saw or face down using a circular saw.
6. Use Titebond® Advanced Polymer Adhesive.

## Condition Panels

Induro™ ACM Panels should be allowed to acclimate to the room environment prior to installation. After unpacking, place panels in the room where they will be installed for at least 48 hours prior to installation.

## Important! Regarding High Humidity Areas:

For applications that require silicone sealant, we recommend the use of Marlite brand Silicone Sealant, available in clear (MS-250) and white (MS-251). In high moisture or wet areas, Trim Molding should surround all panels and be properly sealed with a continuous bead of sealant.

## Panel Layout

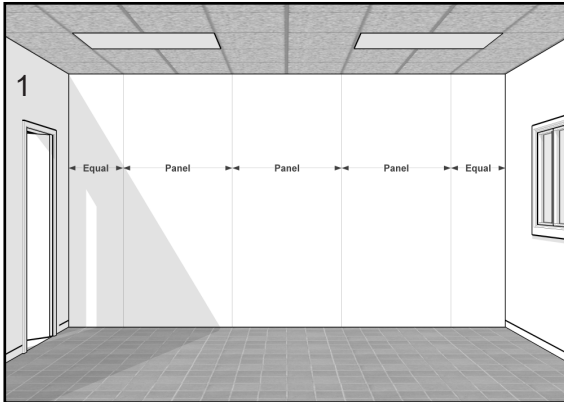

For a balanced appearance, establish a center line of area to be covered. (see illustration 1)

## Installation Steps for Aluminum Trim Molding

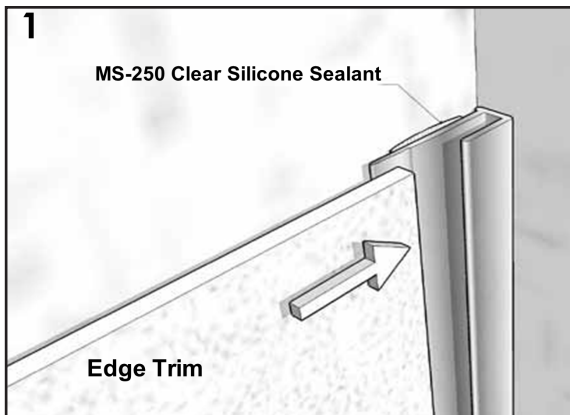

### Important:

Moldings should surround all panel edges. **Do not jam panels tight into trim** (allow room for panel expansion). Apply a 1/8" bead of Marlite brand MS-250 Clear Silicone Sealant on the back of the trim flange along the full length of all trim. (See illustration 2)

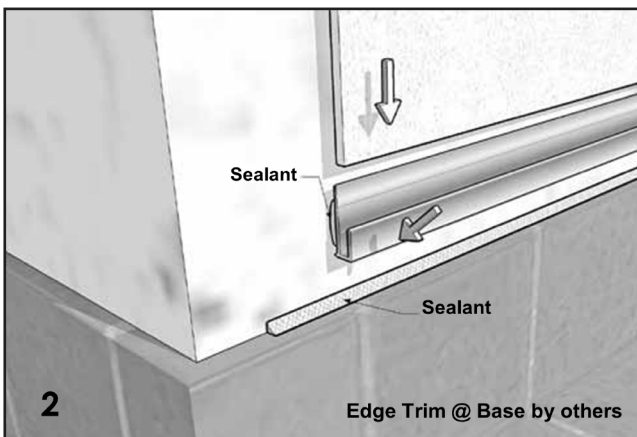

## Installation Steps for Aluminum Trim Molding Continued

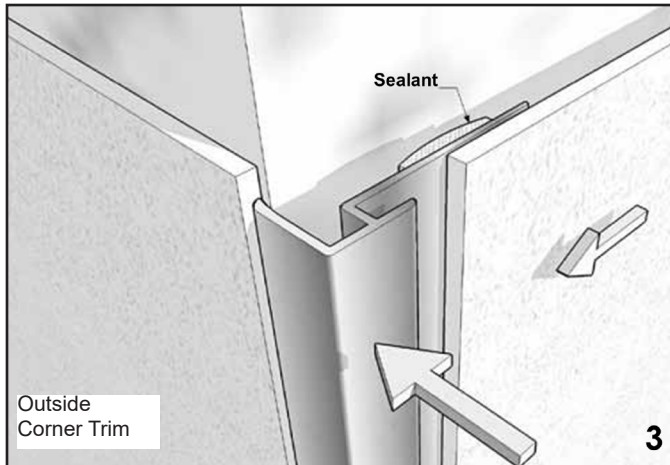

At the outside corner set panel an 1/8" from the corner to allow for expansion. Add the outside corner trim and set the next panel into the trim. (See illustration 3)

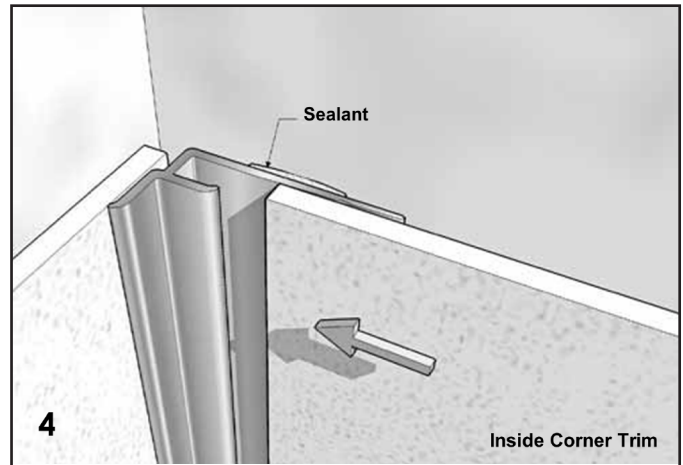

At the inside corner set panel to the adjacent wall leaving a 1/8" gap to allow for expansion. Add the molding trim and set the next panel into the trim. (See illustration 4)

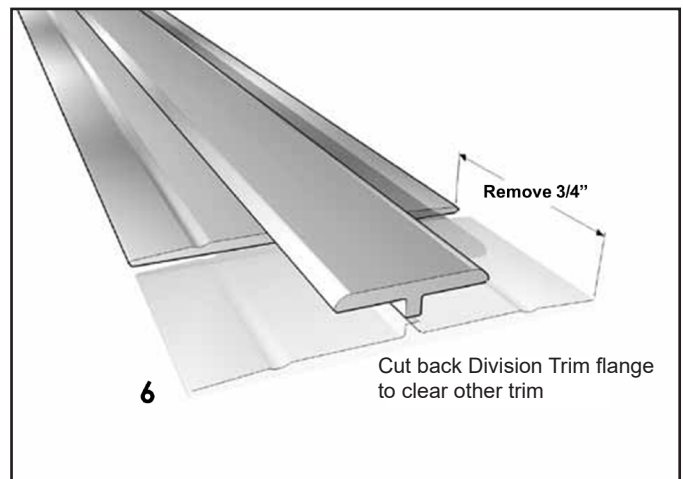
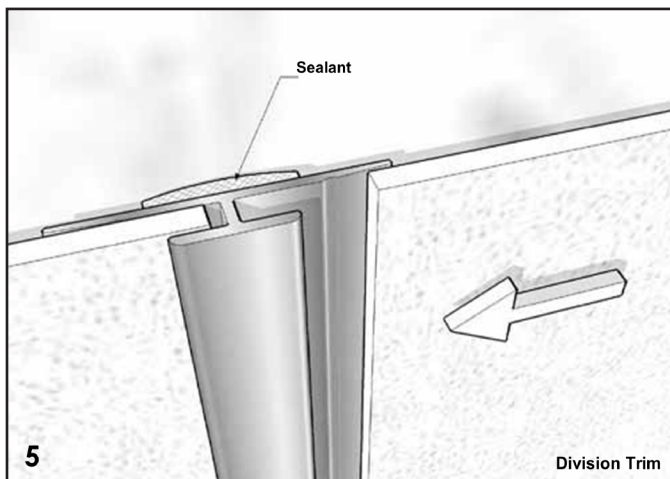

# Installing Induro™ ACM Panels

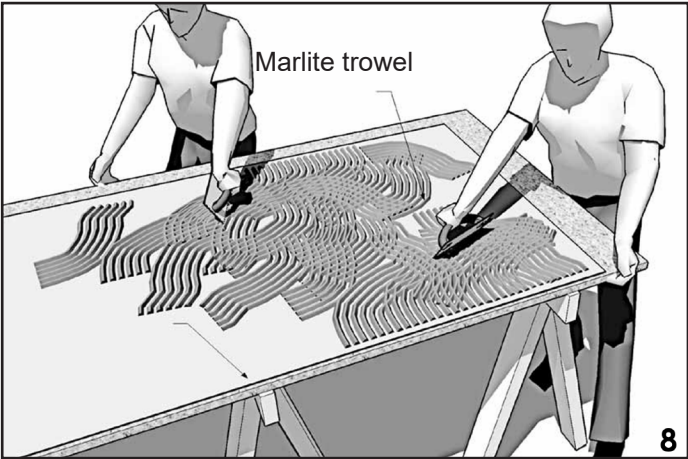
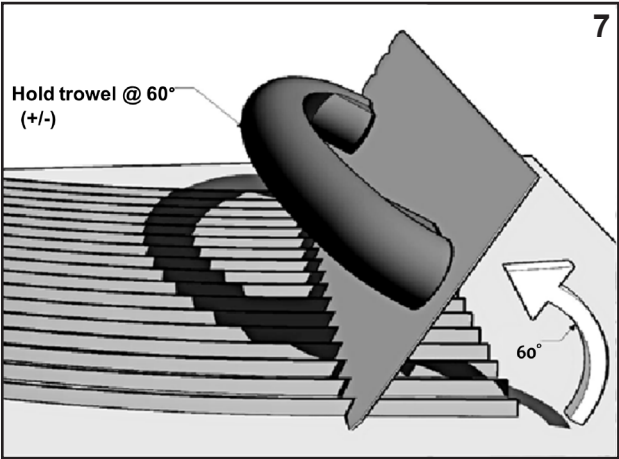

100% coverage except 1" from edges and cutouts. (See illustration 8)

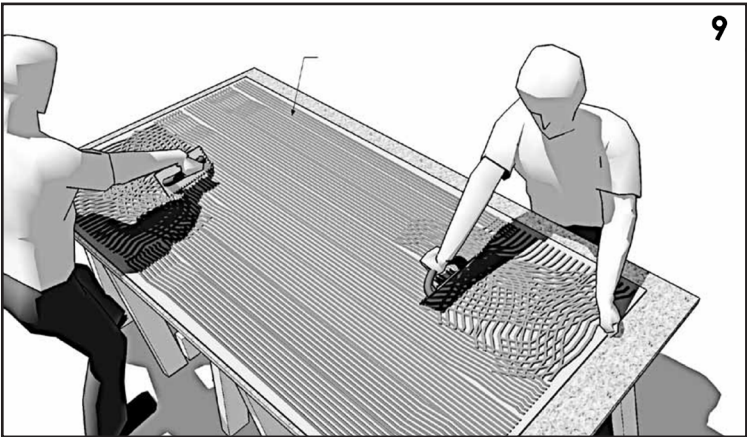

Quickly comb thru Titebond Advanced Polymer adhesive to even and remove excess. (See illustration 9)

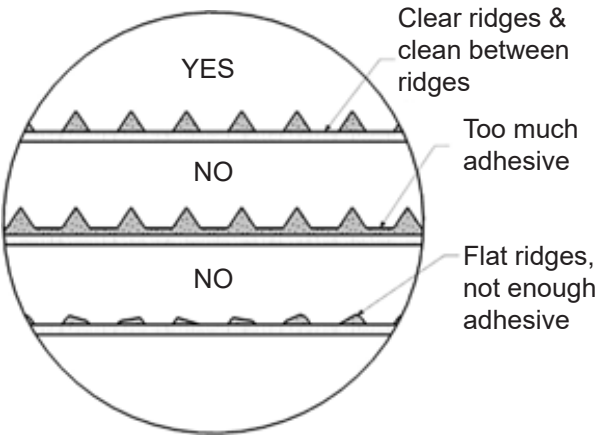

## Installing Induro™ ACM Panels Continued

Check for any cutting or trimming required to get panels ready for installation. Cut as required.

Always dry fit panels before adding Titebond Advanced Polymer adhesive.

Apply Titebond Advanced Polymer adhesive and install panels. Two people are required to install large panels. Don't jam panels tight into trim, allow room for expansion.

After panel is in place, press and/or slap the surface to make contact. **A laminate roller is required to adequately press the panels for full contact. Pay extra attention to properly rolling along edges.**

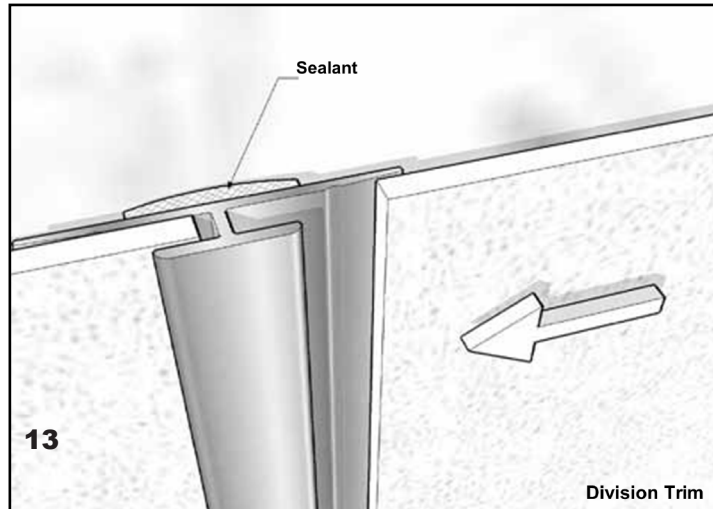
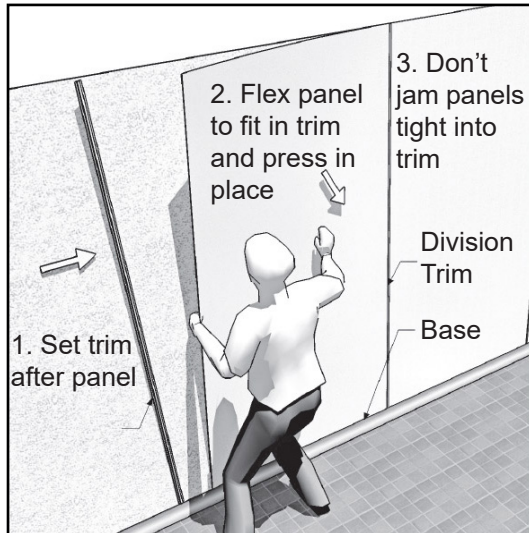

Use a pencil to mark the edge of your panel. From this line, pull the panel back about 1/16" to allow for expansion.

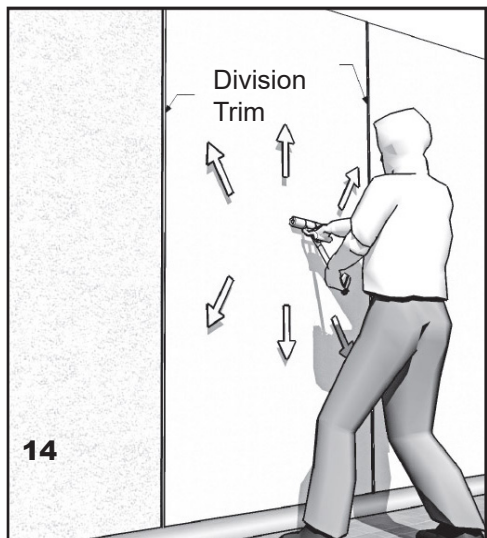

Required:  
Press & roll from center over entire panel



## Cutting Induro™ ACM Panels

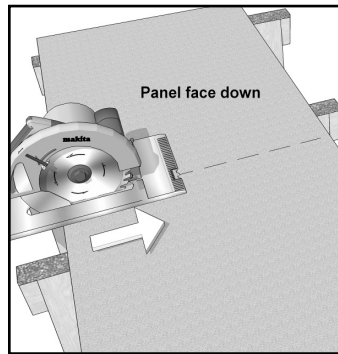
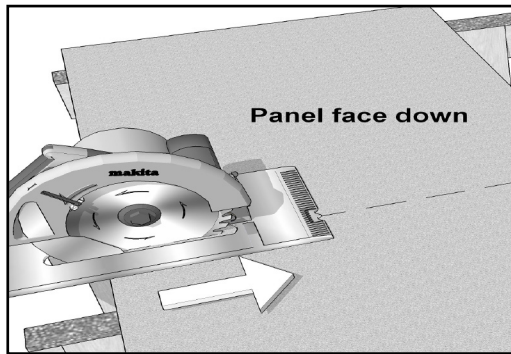

For a clean cut use a new blade when cutting panels.

Cut Induro™ ACM Panels face up with a table saw or face down with a circular saw using a fine-tooth blade. For cutouts, drill four holes and radius all corner cuts to avoid chipping.

*If slight chipping occurs from field cuts, ease the edges lightly using a sanding block.*

**Important:** Trim panel to fit properly. All inside corners of cutouts must be radiused as large as possible, 1/4" minimum, to avoid stress cracking. Holes for screws or bolts should be pre-drilled oversized.

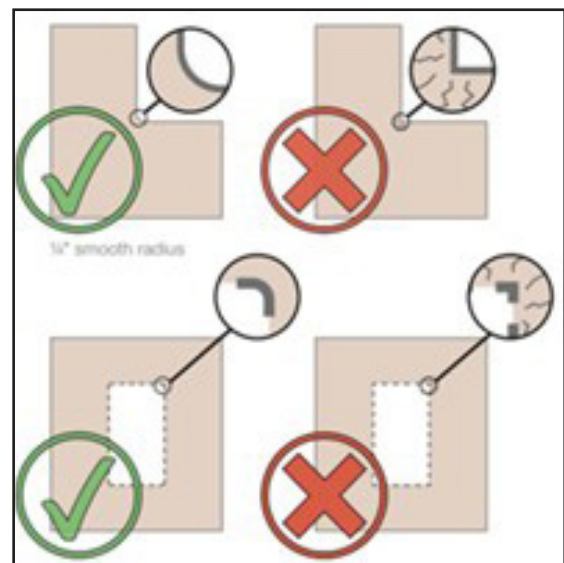

# Induro™ HPL-Faced ACM

## Cleaning Instructions

---

### Overview

For best results, engage in a regular cleaning schedule to avoid dirt build-up. As a general rule, any mild cleaner applied with a sponge or soft brush is safe and effective. Avoid using any cleaner or stain remover considered abrasive or containing chlorinated hydrocarbons or aromatic hydrocarbons.

### Cleaning Agents

The following cleaning agents have been tested and approved. Be sure to test any cleaning agent not appearing on this list in a small, inconspicuous area first.

- Clorox Clean-Up with Bleach
- Pine Sol
- Simple Green
- Mrs Meyer's Clean Day
- Formula 409 Multi-Purpose Cleaner
- Fantastik
- Alcohol Wipes
- Goof Off All Purpose Cleaner
- Mr Clean Magic Eraser
- Windex

### Application Method

Apply the cleaning agent with a sponge or soft brush, working it across the surface in a scrubbing or circular motion. Rinse thoroughly using cold water.

### For Graffiti and Other Stubborn Stains

If the aforementioned cleaning agents fail to remove graffiti or other stubborn stains, the following more powerful agents have been tested and approved for use with caution:

- Misty Vandalism Mark Remover
- Censor Vandalism Mark Remover
- Goof Off Graffiti Remover
- Denatured Alcohol
- Alcohol Wipes

*Please note:* These powerful cleaning agents are flammable. Be sure to take proper precautions when using these or any flammable materials.

# Induro™ HPL-Faced ACM

## Technical Data

### Product

Induro™ Decorative Laminate ACM is an exceptionally wear resistant panel created through a lamination process. The face material is High-Pressure Laminate (HPL) available in a wide array of woodgrains, solid colors, and abstract prints from Wilsonart®, Formica®, Nevamar® and other major HPL manufacturers. The core is an aluminum composite material (ACM) with a High Density Polyethylene (HDPE) center. A balancing backer is applied for panel stability. Induro™ ACM is lightweight, installs easily, and is the most cost-effective way of applying laminate to walls.

### Features & Attributes

- Select from thousands of laminates available from major HPL manufacturers.
- Offers outstanding HPL durability commonly used as door faces, tabletops, and case goods.
- Balanced for panel integrity.
- Coordinates beautifully with HPL doors, tabletops and case goods.
- Class C fire-rating.

### Applications & Uses

Marlite Induro™ ACM lets you design any look you want – warm or cool, rich, rustic, serene or bold. Ideal for all types of public service areas in hospitals, schools and recreational facilities along with enhancing classrooms, hospital rooms and waiting room. It is also great for upscale chains that want a consistent look in all locations that's fast and easy to install and deliver low-maintenance peace of mind.

### Product Identification

Flame Spread ≤25 Class I/A

≤200 Class III/C

Smoke Developed ≤450

### INDURO™ ACM

Standard Items	Available Sizes	Core Color	Score Line	Trim Molding	Sealant	Packaging & Weight
Woodgrains	4' x 8' 4' x 10' .150" nominal panel thickness	Black	Unscored	Per Spec	Per Spec	32 sq. ft. / 32 per pc 40 sq. ft. / 40 per pc
Abstracts	4' x 8' 4' x 10' .150" nominal panel thickness	Black	Unscored	Per Spec	Per Spec	32 sq. ft. / 32 per pc 40 sq. ft. / 40 per pc
Solids	4' x 8' 4' x 10' .150" nominal panel thickness	Black	Unscored	Per Spec	Per Spec	32 sq. ft. / 32 per pc 40 sq. ft. / 40 per pc
Custom * Per customer specification	4' x 8' 4' x 10' .150" nominal panel thickness	Black	Unscored	Per Spec	Per Spec	32 sq. ft. / 32 per pc 40 sq. ft. / 40 per pc



## Physical Properties

Property	ASTM Procedure	Typical Value Induro ACM
Flexural Strengths (psi)	D790	11,500
Flexural Modulus (psi)	D790	1,000,000
Tensile Strengths (psi)	D638	7,350
Tensile Modulus (psi)	D638	1,000,000
Barcol Hardness	D2583	65
Izod Impact Strengths (ft/in)	D256	2
Thermal Coefficient of Lineal Expansion (in/in/F)	D696	$2.46 \times 10^{-5}$
Water Absorption (%)	D570	3.7%
Specific Gravity	D792	1.54
Abrasion (L)	D968	137
Adhesion	D2197	Pass @ 10 kg
Fire Ratings	E-84	Class III/C
Flame Spread		≤200
Smoke Generation		≤450

## Installation Overview

**Safety** – use eye protection. Wear filter mask to cover nose and mouth, especially when cutting panels.

**Tools Required** – power saw (carbide tip), saber saw (metal cutting blade), caulking gun, tape measurer, drill, file, hammer, level, saw horses and supports.

**IMPORTANT - See Induro™ ACM Installation Instructions for complete details.**

## Accessories

- Marlite Aluminum Bright Satin Anodized Trim Molding, 10' lengths.
- Marlite Brushed Satin Stainless Steel Outside Corner Guards, 8' & 10' lengths.
- Titebond® Advanced Polymer Panel Adhesive – VOC compliant, non-flammable, environmentally safe.
- Marlite MS-250 Clear Silicone Sealant

## Cleaning Guidelines

When a regular cleaning schedule is executed, soil and dirt will not build up. A mild, non-abrasive cleaner is effective.

## For Additional Information, see:

www.marlite.com  
 Induro™ ACM Brochure  
 Induro™ ACM CSI Specifications  
 Induro™ ACM Installation Instructions  
 Induro™ ACM Cleaning Instructions

## Panel Specifications

1. Panel dimensions are:

**Panel thickness:** .150" nominal

**Width:** 48" +/- 1/8"

**Length:** specified length 96" +/- 1/8"

**Squareness:** not to exceed 1/8" for 8' or 5/32" for 10' panels

2. Panels shall be installed in strict accordance with Induro™ ACM Installation Instructions.

## Approvals & Certifications

- Class III/C Fire Ratings per ASTM E-84 flame spread and smoke development tests
- Meets USDA/FSIS requirements

## Storage & Preparation

Carefully inspect all panels prior to installation. Notify Marlite at once if panels are deemed unacceptable. Induro™ ACM Panels should be stored indoors on a flat, clean, dry surface for at least 24 hours prior to installation. Room and material (panels and adhesive) temperature should both be at or near 70°F at the time of installation. Induro™ ACM is intended to be installed over unfinished, untreated plywood or unfinished, untreated drywall.

Contact Marlite prior to installing over other substrates.